

**B12,B15,B18,B21**

**ASSEMBLY INSTRUCTIONS**

**Getting started:**

prepare a protection layer, a screwdriver

STEP 1: Joint side panel with back panel

STEP 2: Joint bottom panel with side panel

STEP 3: Joint side panel with bottom & back panel

STEP 4: Attach frame on and toekick board

STEP 5: Joint the drawer together, then install the drawer guide.

STEP 6: Attach the plastic block on the top corner, and put on the adjustable shelf

STEP 7: Fix drawer head on the drawer front and fix door onto the frame and adjust the cover-space

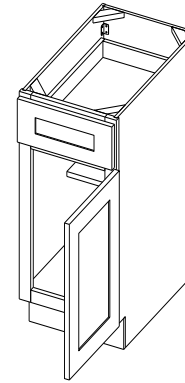

PARTS LIST		
NO.	Description	QTY
A	BACK PANEL	1
B	SIDE PANEL	2
C	TOP&BOTTOM PANEL	1
D	TOE KICK	1
E	FACE FRAME	1
F	DRAWER BOX FRONT AND BACK	2
G	DRAWER BOX SIDE	2
H	DRAWER BOX BOTTOM	1
I	ADJUSTABLE SHELF	1
J	DRAWER HEAD	1
K	CABINETS DOOR	1

11	1/2" HINGE	2	
10	3/4" ROUND HEAD SCREW	2	
9	BUMPER	6	
8	1" ROUND HEAD SCREW	4	
7	Epoxy Slide	1	
6	SHELF CLIP	4	
5	9/16" ROUND HEAD SCREW	40	
4	CLEAT	10	
3	1" FLAT HEAD SCREW FOR CARCASS	10	
2	Plastic Block	4	
1	9/16" flat head screw	18	
NO.	Description	QTY	PICTURE

**HARDWARE LIST**

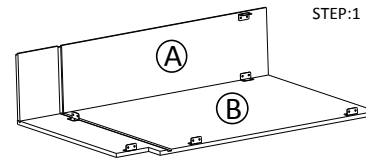

STEP:1

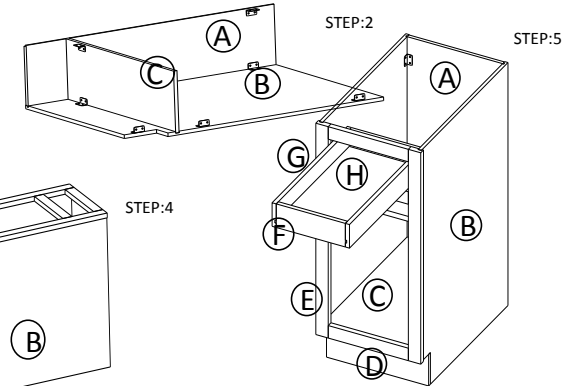

STEP:2

STEP:5

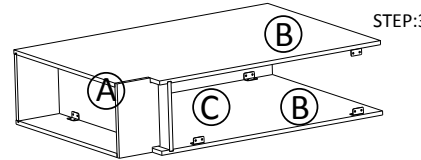

STEP:3

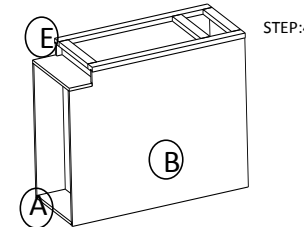

STEP:4

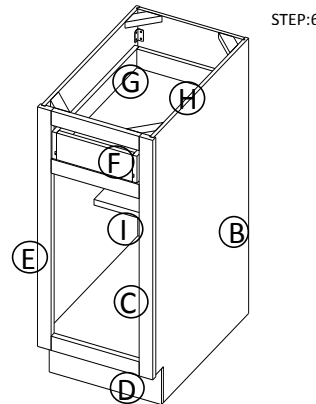

STEP:6

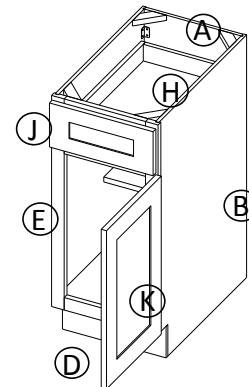

STEP:7

**Epoxy sidemount drawer runners**

